



Notice of Alvin St One way system – 2nd June – early October 2026

Montel Civil Engineering has been appointed by **Gloucestershire County Council** as the main contractor to deliver improvements and cycleways along London Road and Black Dog Way.

On the 2nd of June we are introducing a new temporary one-way system on Alvin Street. This will enable our work to take place safely on the junction of London Road/Alvin Street. The one-way system will remain in place until early October. During this period, there will be no entry to Alvin Street from Kingsholm Road. Residents will need to access Alvin Street via the London Road junction instead. Traffic approaching from the Kingsholm Road end will be diverted along a fully signposted route.

Please be aware that the bus stop on London Road outside Badham's Pharmacy will be suspended from the 26th of May. Please accept our apologies for any inconvenience this may cause.

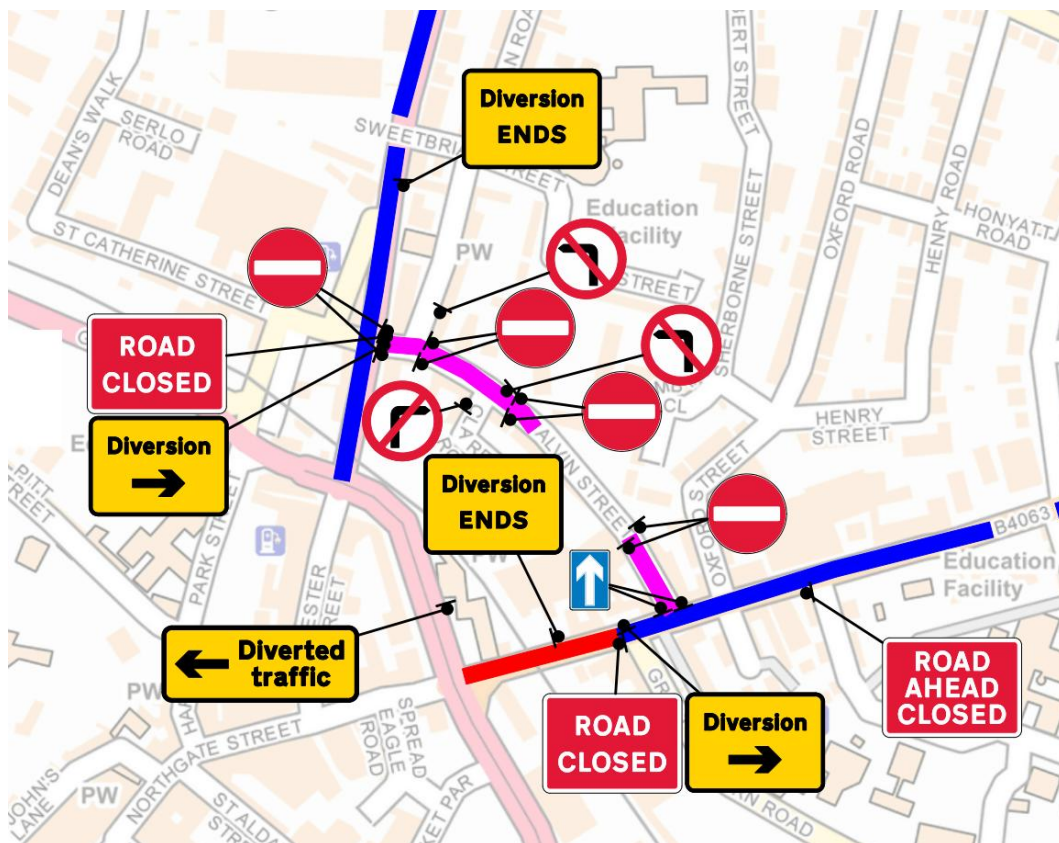

Please see above the diversion plan which show that Worcester Street remains open, but is closed at the junction with Alvin Street.

If you have any specific queries, concerns or would like to be added to the mailing list:
Please contact: blackdogway@montel-group.com